

SERIES

# SKA DDL 100.1200 – 100.1600

**FORCE [N]**  
**1200/1600**

SINEWAVE FORM		SYMBOL	UNITS	TYPE OF WINDING <b>XX = preferential winding</b>		
				15	16	17
MOTOR SPEED	Vn drive 145 V (ac) 3phase		[ m/s ]	2	1.5	1.1
	Vn drive 230 V (ac) 3phase		[ m/s ]	3	2	1.5
	Vn drive 400 V (ac) 3phase		[ m/s ]	5	4	3
<b>COMMON RATINGS</b>						
	Voltage constant ± 5%	Ke	[Vrms/m/s]	55	72	97
	Pole pitch	P	[mm]			24
	Temperature range	Tr	[°C]			0 ÷ 40°
<b>SKA DDL 100.1200</b>						
MOTOR RATINGS	Continuous force( 0 m/s )	Fn0	[ N ]			1200
	Peak force	Fmax	[ N ]			3600
	Force constant ± 5%	Kf	[N/Arms]	86		151
	Rated current ( 0 m/s )	In0	[Arms]	14		7.96
	Peak current	I fmax	[Arms]	56		31.8
	Phase/phase res. ± 5% a 20°C	Rff	[Ohm]	0.80		2.5
	Phase/phase inductance	Lff	[mH]	15		44
	Electrical time constant	Te	[msec]			18
	Attraction force	Fm	[ N ]			5831
	Power loss	Pd	[ W ]			345
	Thermal resistance	Rth	[°C/W]			0.26
	Motor constant	Km	[N/√W]			64.6
	<b>SKA DDL 100.1600</b>					
	Continuous force( 0 m/s )	Fn0	[ N ]			1600
	Peak force	Fmax	[ N ]			4800
	Force constant ± 5%	Kf	[N/Arms]		110	147
	Rated current ( 0 m/s )	In0	[Arms]		14.5	10.9
	Peak current	I fmax	[Arms]		56.5	42.3
	Phase/phase res. ± 5% a 20°C	Rff	[Ohm]		1.0	1.9
	Phase/phase inductance	Lff	[mH]		18	33
	Electrical time constant	Te	[msec]			18
	Attraction force	Fm	[ N ]			7774
	Power loss	Pd	[ W ]			460
	Thermal resistance	Rth	[°C/W]			0.19
	Motor constant	Km	[N/√W]			74.6
THERMAL PROTECTION	Type of thermal cut-off					N C : normally closed
	Rated voltage	Vn	[ Vac ]			250
	Rated current	In	[ A ]			2.5
	Operative temperature	Tn	[ °C ]			130 °C ± 5%
	Resetting temperature	Tr	[ °C ]			100 °C ± 15°C
	Operative time		[ ms ]			1
	Insulation class					F

Datasheet n°: SKADDL – 2012-04-18

SERIES

**SKA**

**DDL 100**

FORCE [N]

**1200/1600**

**MOTOR DIMENSIONS**

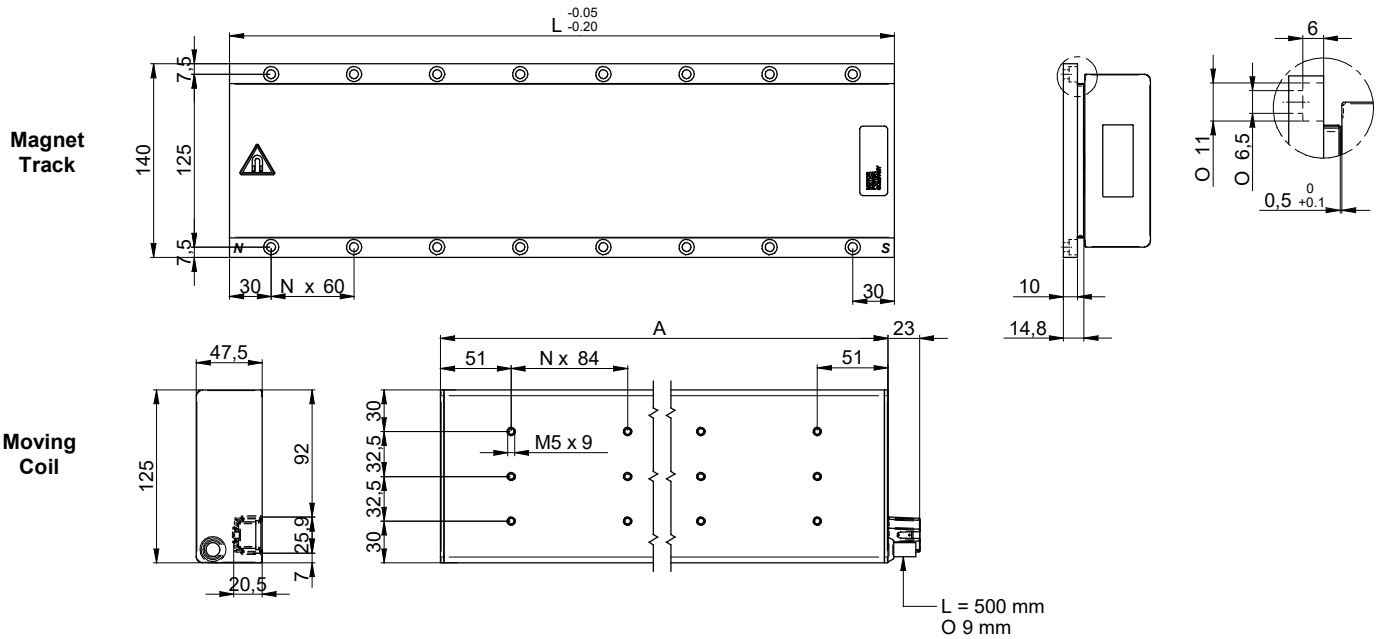

Magnet Track		Moving Coil	
Type	L (mm)	Type	A (mm)
100-120	120	100.1200	522
100-240	240	100.1600	690
100-480	480		

