

Motor ECM48 with worm gear SN31

- zinc die-cast gearhousing, hardened steel worm wheel, permanent grease lubrication, output with ball bearing, optional second shaft or output shaft left
- Other reductions, output shaft or connection cable on request

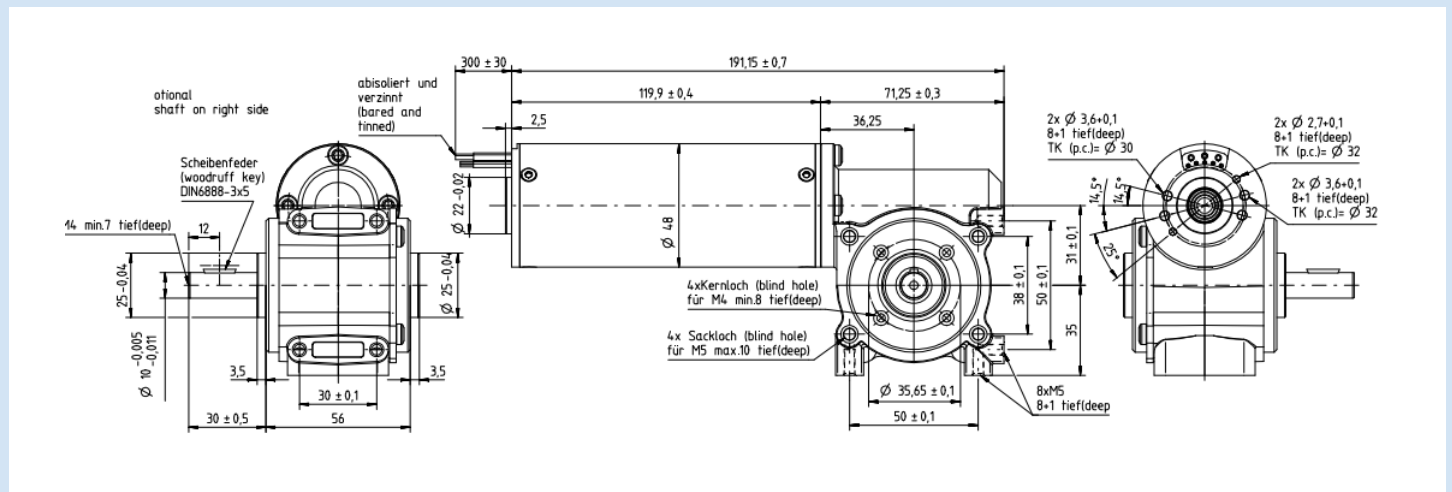

Gear reduction table ECM48xXX/I+ SN31

Application on request

Gear reduction	Efficiency of the gear	Speed at motor-speed 3000rpm	Nominal torque in S1-operation		
			ECM48x20/I L2 = 80 mm	ECM48x40/I L2 = 100 mm	ECM48x60/I L2 = 120 mm
[i = x:1]	[%]	[1/min]	[Ncm]	[Ncm]	[Ncm]
7	69	428,5	28,98	77,28	111,09
10	66	300	39,6	105,6	151,8
15	62	200	55,8	148,8	213,9
25	52	120	78	208	299
38	46	78,9	104,88	279,68	402,04
50	40	60	120	320	460

Gear reduction	Efficiency of the gear	Speed at motor-speed 3000rpm	Nominal torque in S3-operation		
			ECM48x20/I L2 = 80 mm	ECM48x40/I L2 = 100 mm	ECM48x60/I L2 = 120 mm
[i = x:1]	[%]	[1/min]	[Ncm]	[Ncm]	[Ncm]
7	78	428,5	79,14	131,04	188,37
10#	79	300	71,5	189,6	272,55
15#	77	200	103,95	277,2	398,48
25	58	120	130,5	348	500,25
38	50	78,9	171	456	655,5
50	44	60	198	528	759

*) Motor have to be operated with current limitation

#) plastic design

General gear data

Material worm wheel		Plastic	Brass
Maximum torque	[Ncm]	800	1200
Permissible shaft load	[N] (axial / radial)	200 / 500	200 / 500
Gear length	[mm]	71	71

Stand: 24. Juli 2020 – changes reserved